



www.apecpump.com



# DIGITAL PRESSURE CONTROL SWITCH



**APEC PUMP ENTERPRISE CORP.**

3F, No. 394, Sec. 2 Mingzhi Rd., Taishan Dist., New Taipei City 243, Taiwan.  
TEL : +886-2-29034567 FAX : +886-2-29064567  
E-mail : sales@apecpump.com



www.apecpump.com



VolDPS18071

**APEC PUMP ENTERPRISE CORP.**



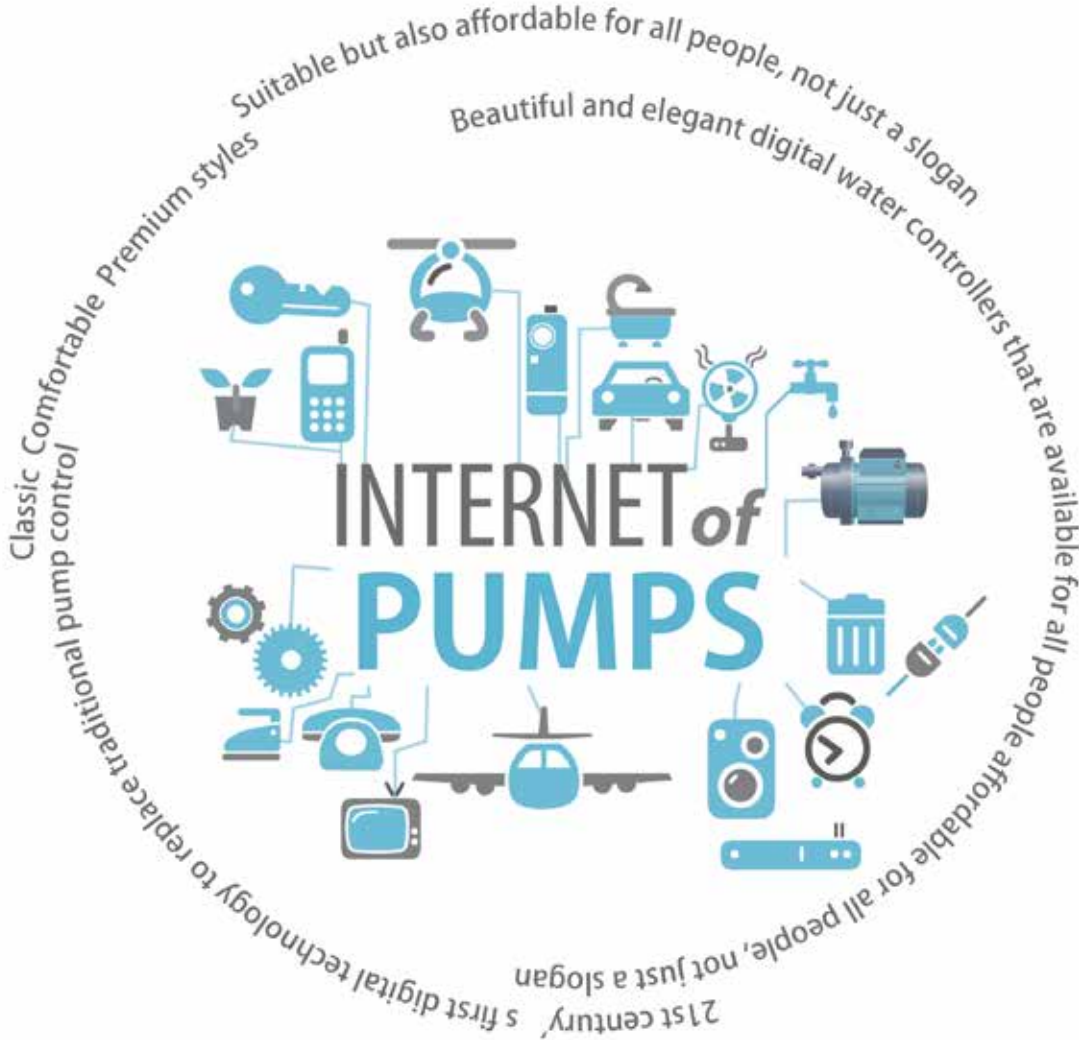

Attention: We reserve all the rights of our intellectual design and hardware of all our digital pressure controllers. Global Patented, copying and piracy will be investigated.



CLASSIC DPS-10 Series



• Digital Pressure Switch can completely replace and outperform the pressure gauge-pressure switch kit on a pressure tank system and/or the pressure control device

FEATURE



- LCD screen with different backlit colors for demonstrating pump status and for anytime view
- Digital Pressure Switch is characterized by its accuracy and high resolution
- Delayed Shutdown function - Prevention of overloading of maximum start
- Dry running protection
- Auto-restart in event of water shortage
- Able to work with three phase pumps with a contactor with required voltage to Digital Pressure Switch

MODEL SELECTION

\*Cooperation with customers with required specific settings is advisable

MODEL (MALE R 1/4")	MODEL (FEMALE G 3/8")	Working Pressure
DPS-10-A-M	DPS-10-A-F	1.0 – 1.8
DPS-10-B-M	DPS-10-B-F	1.2 – 2.4
DPS-10-C-M	DPS-10-C-F	1.4 – 2.8
DPS-10-D-M	DPS-10-D-F	2.0 – 3.0
DPS-10-E-M	DPS-10-E-F	2.4 – 3.6
DPS-10-F-M	DPS-10-F-F	2.8 – 4.0
DPS-10-G-M	DPS-10-G-F	4.0 – 6.0

APPLICATION

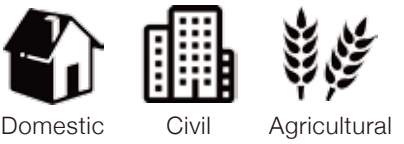

Booster with 5 way check valve - check valve built-in

TECHNICAL DATA

Power Supply	115~220Vac±10% 50/60hz
Pressure Connection	MALE R 1/4" - G 3/8" FEMALE
Port Material	POM
Enclosure size	2"
Accuracy	± 1% Tolerance
Overload Capacity	Tested to 1.5 x the rated pressure
Output of Relay	ON/OFF
Relay Capacity (Maximum Motor Size)	110V up to 1HP (0.75kw) 220V up to 2HP (1.5kw)
Maximum Current	12A
Sampling rate	5 times/second
Working Temperature	-10°~65°C
Ingress Protection	IP54
Display Pressure Unit	BAR

\*All technical information are subject to change without notice

DIMENSION

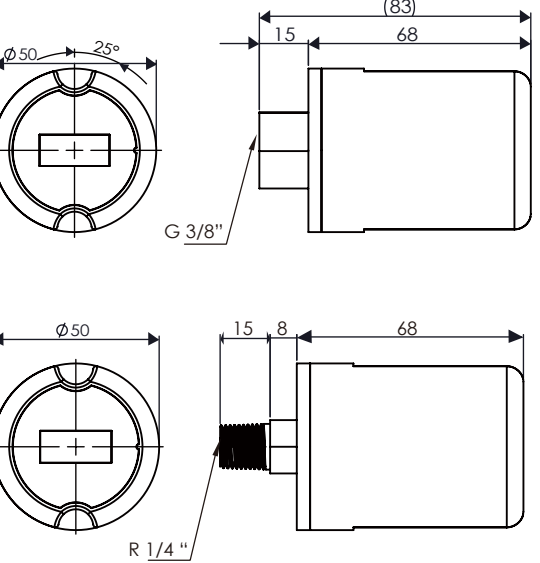

Unit:mm

# COMFORT DPC-10 / DPC-10A Series



- Digital Pressure Switch can completely replace and outperform the pressure gauge pressure switch kit on a pressure tank system and/or the pressure control device
- Digital Pressure Switch is characterized by its accuracy and high resolution
- Autonomous protection to equipment and system

### FEATURE



- All time status display and LCD backlit for anytime view
- Clearly indicating 3-color LED light for reporting Status
- Protection limiting maximum starts per hour, protecting the pump from high frequent cycling per hour
- Protection adjustable restart delay 0~90 minutes, controlling the pump cycle rate
- Delayed Shutdown function - Prevention of overloading of maximum start
- Auto-restart in event of water shortage and resupply pressure when water source is available
- Resource-protection: Auto-shutdown in the event the maximum run time is exceeded: great for protecting against burst water pipe
- Fast response to accuracy and setting
- Anti-vibration, anti-jamming ability
- Easy to connect the wires and install
- Reset IC installed – permanent memory of setting – will not lose setting even loss of power
- Able to work with three phase pumps with a contactor with required voltage to Digital Pressure Switch

### APPLICATION



### MODEL SELECTION

- All DPC series are able to adjust based on users' required parameters

MODEL	Maximum Pressure	Enclosure Size	Port Material
DPC-10	10 BAR	3"	BRASS
DPC-16	16 BAR	3"	SUS304
DPC-25	25 BAR	3"	SUS304
DPC-10A	10 BAR	3 1/2"	BRASS

### TECHNICAL DATA

Power Supply	110~230Vac±10% 50/60hz
Pressure Connection	BSP 1/4"
Accuracy	± 1% Tolerance
Overload Capacity	Tested to 1.5 x the rated pressure
Output of Relay	ON/OFF
Relay Capacity (Maximum Motor Size)	110V up to 1HP (0.75kw) 230V up to 2HP (1.5kw)
Maximum Current	12A
Sampling rate	5 times/second
Working Temperature	-10°~65°C
Ingress Protection	IP55
Display Pressure Unit	BAR-PSI-Kg/CM²
Ph level	6-9

\*All technical information are subject to change without notice



### DIMENSION

Dimension(mm)			
MODEL	A	B	C
DPC-10	96	77	46
DPC-16	96	77	46
DPC-25	96	77	46
DPC-10A	103	85	55

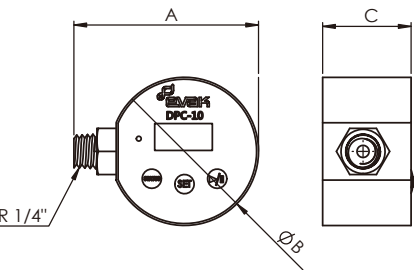

# PREMIUM DPC-10-BT Blue Tooth Connection



- Digital Pressure Switch can completely replace and outperform the pressure gauge-pressure switch kit on a pressure tank system and/or the pressure control device
- Digital Pressure Switch is characterized by its accuracy and high resolution
- Autonomous protection to equipment and system

### FEATURE



- DPC-10-BT blue tooth connection and control by mobile phone within distance
- All time status display and LCD backlit for anytime view
- Clearly indicating 3-color LED light for reporting Status
- Protection limiting maximum starts per hour, protecting the pump from high frequent cycling per hour
- Lock screen function to prevent non-user modifying parameter settings
- Protection adjustable restart delay 0~90 minutes, controlling the pump cycle rate
- Delayed Shutdown function - Prevention of overloading of maximum start
- Auto-restart in event of water shortage and resupply pressure when water source is available
- Resource-protection: Auto-shutdown in the event the maximum run time is exceeded: great for protecting against burst water pipe
- Fast response to accuracy and setting
- Anti-vibration, anti-jamming ability
- Easy to connect the wires and install
- Reset IC installed – permanent memory of setting – will not lose setting even loss of power
- Able to work with three phase pumps with a contactor with required voltage to Digital Pressure Switch

### APPLICATION



### MODEL SELECTION

MODEL	Working Pressure	Enclosure Size	Port Material
DPC-10-BT	10 BAR	3"	BRASS

### TECHNICAL DATA

Power Supply	110~230Vac±10% 50/60hz
Pressure Connection	BSP 1/4"
Accuracy	± 1% Tolerance
Overload Capacity	Tested to 1.5 x the rated pressure
Output of Relay	ON/OFF
Relay Capacity (Maximum Motor Size)	110V up to 1HP (0.75kw) 230V up to 2HP (1.5kw)
Maximum Current	12A
Sampling rate	5 times/second
Working Temperature	-10°~65°C
Ingress Protection	IP55
Display Pressure Unit	BAR-PSI-Kg/CM²
Ph level	6-9

\*All technical information are subject to change without notice

### DIMENSION

Dimension(mm)			
MODEL	A	B	C
DPC-10-BT	96	77	46

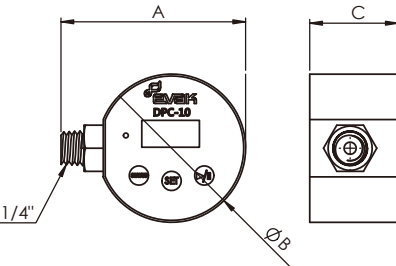



# PUMP CONTROLLER SETTING TO APPLICATION

- Delay time keeps the pump running once the Pmax has been exceeded, reduces over cycling issues (delay time can be set up to 60 seconds)
- System curve is static head plus frictional losses, in pipework friction increases with flowrate
- Rundry time is the length of time in seconds that the pump is allowed to operate below the rundry pressure. Once this time frame is exceeded the DPC will wait up to 600 seconds before attempting to restart a maximum of 10 restarts are permitted before manual intervention is required.

## How pressure settings relate to the pump curves and a typical application

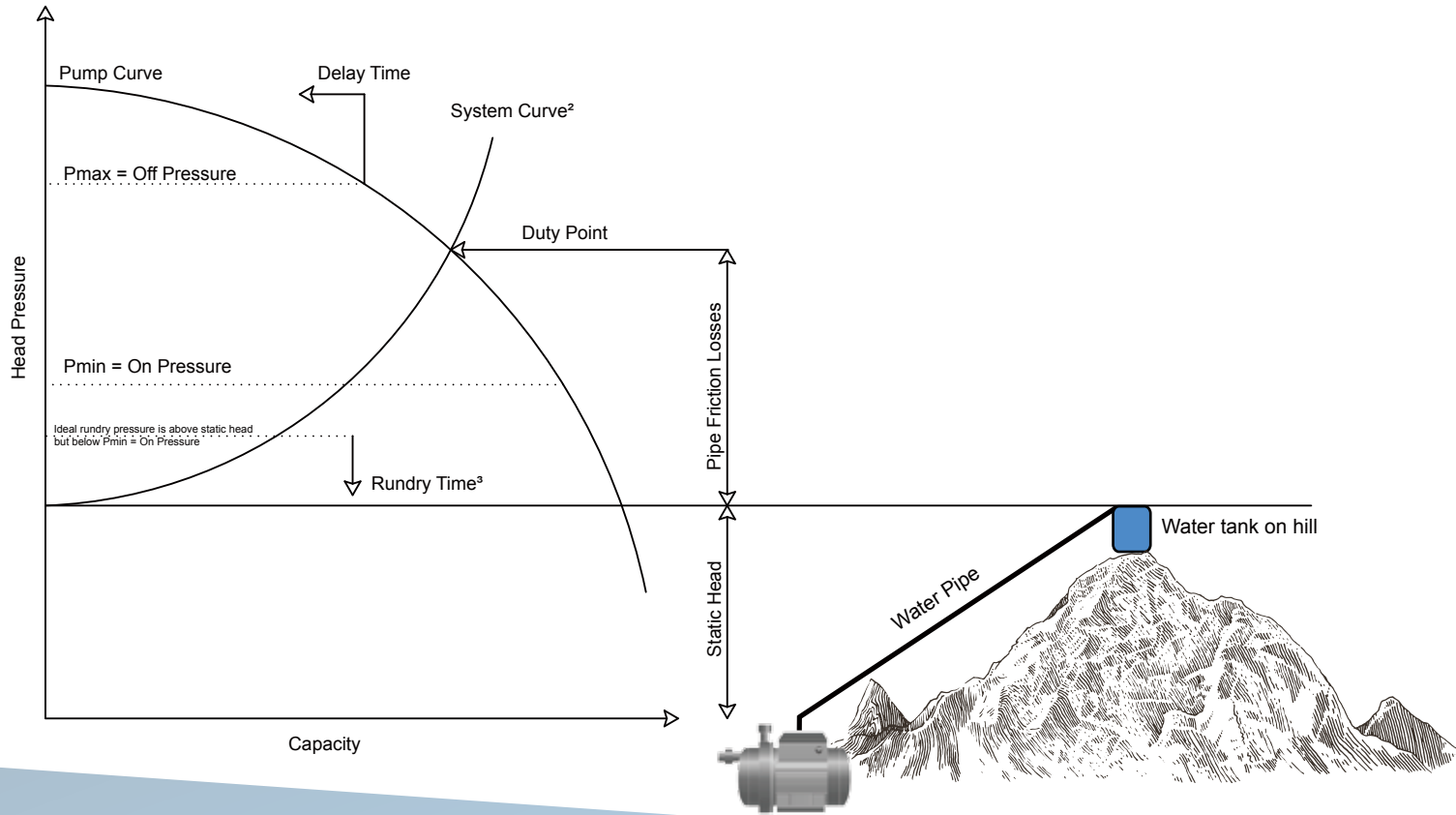

# DIGITAL PRESSURE TRANSMITTER

## DPT-1900



- Digital Pressure Switch can completely replace and outperform the pressure gauge-pressure switch kit on a pressure tank system and/or the pressure control device
- Digital Pressure Switch is characterized by its accuracy and high resolution
- Autonomous protection to equipment and system

## FEATURE



- Designed for use in water applications
- Reading unit on LCD interchangeable to PSI-Bar-Kg/cm<sup>2</sup>
- Anytime view backlit LCD display
- Relative (gauge) sensor element
- Easy to connect the wires and install

## MODEL SELECTION

MODEL	Working Pressure	Enclosure Size	Port Material
DPT-1900	10 /16 /25 BAR	3"	NICKEL BRASS

## APPLICATION



## TECHNICAL DATA

Output Signal	4~20mA
Pressure Connection	R 1/4"
Resolution	0.1psi/0.01bar/0.01kg/cm <sup>2</sup>
Measuring Accuracy	± 1% Tolerance (@22~28°C) ± 2% Tolerance (@0~22 & 28~50°C)
Supply Voltage	10~30Vdc
Readout (measuring) range	1~10bar / 1~16bar / 1~25bar
Burst Pressure	15 BAR
Response Time	40ms
Ingress Protection	IP55
Pressure Port Materia	Nickel brass
Housing Material	PC/ABS
Ambient temperature range	0~55°C
Storage & medium temperature range	-10~65°C

\*All technical information are subject to change without notice

## DIMENSION

