

APEC VMO-Series 4" Submersible Motor



VMO

VMO 4" 60Hz

Feature

- > Removable waterproof cable connector
- > Non-toxic oil (FDA approved)
- > Motor casing & shaft made of SST
- > Special motor design for high starting torque & efficiency
- > Zinc-plated cast iron upper bracket
- > All motors 100% tested

Application

- > Designed for a directly connected submersible pump for deep well.

VMO4 Dimensions And Weights

Single-Phase Motors 60HZ				
Type	P2		H	Weight
	KW	HP		
VMO4-6.05S	0.37	0.5	346	7.3
VMO4-6.07S	0.55	0.75	365	8.2
VMO4-6.10S	0.75	1	380	8.8
VMO4-6.15S	1.1	1.5	405	10.0
VMO4-6.20S	1.5	2	440	11.5
VMO4-6.30S	2.2	3	495	14.0
VMO4-6.50S	3.7	5	683	22.7

Three-Phase Motors 60HZ				
Type	P2		H	Weight
	KW	HP		
VMO4-6.05T	0.37	0.5	330	6.7
VMO4-6.07T	0.55	0.75	346	7.4
VMO4-6.10T	0.75	1	365	8.2
VMO4-6.15T	1.1	1.5	380	8.9
VMO4-6.20T	1.5	2	405	10.0
VMO4-6.30T	2.2	3	440	11.6
VMO4-6.40T	3	4	516	15.2
VMO4-6.55T	4	5.5	607	19.5
VMO4-6.75T	5.5	7.5	683	23.1
VMO4-6.100T	7.5	10	783	27.5

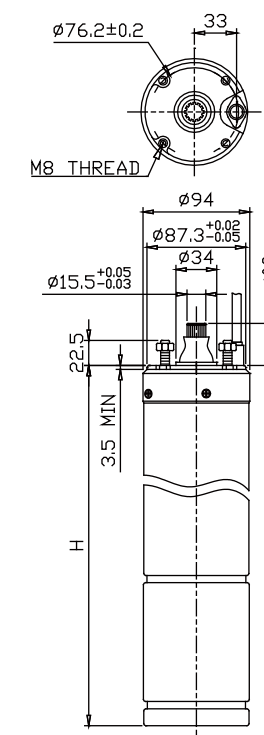

Unit(mm)

4" Oil Filled Submersible Motors

> The new development of 4" APEC rewindable submersible motors has made a breakthrough in technology. It is a rewindable submersible motor including the characteristics of removable waterproof cable connectors for easy maintenance, an extremely long service life, good performance within wider voltage fluctuations. The components, such as mechanical seal, copper winding wires and insulations are of superior quality. All APEC submersible motors are tested under the most stringent quality control procedures.

General Specifications

Mounting flange	4" NEMA standard
Degree of protection	IP 68
Insulation class	F
Single phase motors	0.37kw up to 3.7kw
Three phase motors	0.37kw up to 7.5kw
Standard voltages	1~110Vor230V
	3~230V or 400V
Cable length	1.7M 0.37kw up to 1.5kw
	2.5M 2.2kw up to 7.5kw

Operating Parameters

Max voltage variation	±10%
Liquid characteristics	Clear water
Max starts / h	40
Max water temperature	35°C
Flow rate	0.2m/sec
Flow rate	2000N from 0.37kw up to 1.5kw
Axial thrust	3000N 2.2kw
	5000N from 3kw up to 7.5kw
Max immersion depth	200m

Material Specifications

Part	Material
Motor Shell	304 Stainless steel
Sand Guard	NBR
Cable Connector	EPDM
Upper end bracket cover	304 Stainless steel
Upper end bracket	Zinc plated cast iron
Mechanical seal	Ceremic/Carbon
Shaft (0.5 - 10 HP)	304 Stainless steel/S45C
Rotor (0.5 - 3 HP)	Aluminum
Rotor (4 - 10 HP)	Copper
Connector	PPS
Winding	Copper
Lower end bracket	Aluminum
Lower end bracket cover	304 Stainless steel
Diaphragm	NBR



Option : Plastic control box
For single phase(3wire)

VMO4 Selection Chart

VMO4 60Hz (Single-Phase)												
Type	P2		Voltage	S.F	In	Imax	Istart	Efficiency	Nn	Thrust Load	Capacitor	Cable
	KW	HP										
VMO4-6.05S	0.37	0.5	110/230	1.6	8.5/4.8	9.8/5.2	30/15	64	3440	2000	65/16	1.5 1.7
VMO4-6.07S	0.55	0.75	110/230	1.5	10.9/5.6	12.8/6.6	38/19	65	3440	2000	80/20	1.5 1.7
VMO4-6.10S	0.75	1	110/230	1.4	11.5/6.3	14.5/7.6	50/25	68	3430	2000	100/25	1.5 1.7
VMO4-6.15S	1.1	1.5	230	1.3	8.7	10.3	34	69	3440	2000	35	1.5 1.7
VMO4-6.20S	1.5	2	230	1.25	10.6	12.2	41	72	3420	2000	40	1.5 1.7
VMO4-6.30S	2.2	3	230	1.15	14.4	16.1	45	70	3420	3000	55	1.5 2.5
VMO4-6.50S	3.7	5	230	1.15	24.2	27.2	64	71	3450	5000	75	1.5 2.5

VMO4 60Hz (Three-Phase)												
Type	P2		Voltage	S.F	In	Imax	Istart	Efficiency	Nn	Thrust Load	Capacitor	Cable
	KW	HP										
VMO4-6.05T2	0.37	0.5	230	1.6	2.7	3.3	10	68	3400	2000		1.5 1.7
VMO4-6.07T2	0.55	0.75	230	1.5	3.8	4.3	17	69	3400	2000		1.5 1.7
VMO4-6.10T2	0.75	1	230	1.4	4.5	5.2	24	72	3420	2000		1.5 1.7
VMO4-6.15T2	1.1	1.5	230	1.3	5.7	6.6	33	72	3430	2000		1.5 1.7
VMO4-6.20T2	1.5	2	230	1.25	7.6	8.5	40	74	3430	2000		1.5 1.7
VMO4-6.30T2	2.2	3	230	1.15	10.3	11.2	48	74	3440	3000		1.5 2.5
VMO4-6.50T2	3.7	5	230	1.15	16.9	18	109	75	3450	5000		1.5 2.5
VMO4-6.75T2	5.5	7.5	230	1.15	25.4	28.5	134	75	3450	5000		1.5 2.5
VMO4-6.100T2	7.5	10	230	1.15	37	39	159	76	3470	5000		1.5 2.5
VMO4-6.05T4	0.37	0.5	400	1.6	1.6	1.9	9	68	3400	2000		1.5 1.7
VMO4-6.07T4	0.55	0.75	400	1.5	2.2	2.5	11	69	3400	2000		1.5 1.7
VMO4-6.10T4	0.75	1	400	1.4	2.6	3	14	72	3420	2000		1.5 1.7
VMO4-6.15T4	1.1	1.5	400	1.3	3.3	3.8	19	72	3430	2000		1.5 1.7
VMO4-6.20T4	1.5	2	400	1.25	4.4	4.9	23	74	3430	2000		1.5 1.7
VMO4-6.30T4	2.2	3	400	1.15	6	6.5	28	74	3440	3000		1.5 2.5
VMO4-6.50T4	3.7	5	400	1.15	9.8	10.4	63	75	3450	5000		1.5 2.5
VMO4-6.75T4	5.5	7.5	400	1.15	14.7	16.5	78	75	3450	5000		1.5 2.5
VMO4-6.100T4	7.5	10	400	1.15	21.5	22.5	92	76	3470	5000		1.5 2.5

All technical information is subject to change without notice.